

BEFORE YOU START! ACCESSING THE EVENTS SCREEN.

Please note that the screen shots shown may be a different orientation to the VenueHub.

In order to set up any of the features on your VenueHub's special events you first need to access the special events menu. This is done by turning the Events key Switch situated on the left hand side of the VenueHub. This will enable the Special Events option Screen. Press **Managers Menu**, This will take you into the main options menu.

START A BINGO GAME. 1. Select **Start Bingo Game**. | 2. The terms & conditions display relating to the gaming law. By pressing **OK** you are accepting these terms & conditions | 3. Enter the amount you wish to play for. A max amount of £2000 is allowed. On this screen if you press **Settings** you can alter the relation to the background sound fx and Bingo Bobs Voice - see 4. | Press **start the game**. | 5. The Game will start. Press the screen to release a new ball. To check off the balls at any point press **View Board**. This will bring up the board view - see 6. you can check off each ball in turn by pressing the relevant ball.

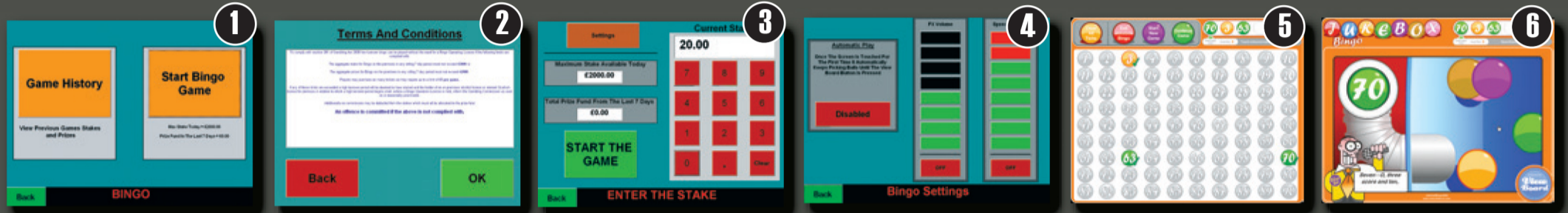

SETTING UP A QUIZ

1. Press **Start New Quiz** | 2. select the categories that you want your quiz to be based on. Select whether you want questions read out from all categories or from only one category per round. | 3. Select the number of rounds | 4. Select whether you want the jukebox to read out the audio or whether you want to read the questions yourself. | 5. Select if you want the quiz to run itself automatically (using timers to control when the next question is read) or if you want to control the quiz yourself. | 6. set up the time delay between each question, each round, the delay between the last question and the first answer and the delay between each answer. | 7. Press **Start** to begin the quiz

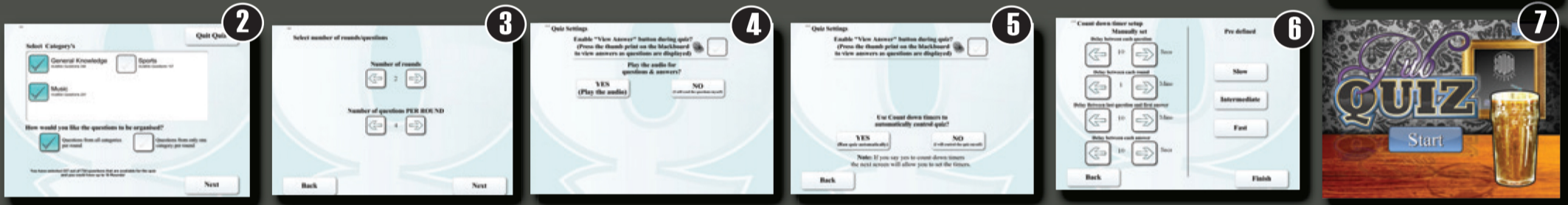

SETTING UP A NEW "WHAT'S ON EVENT"

1. Press **New What's on event** | 2. Give the event a title | 3. Select the icon you want to associate with the event. | 5. Enter a start time for the event in a 24 hour clock format. | 6. Enter a full description of the event. | 7. Select if the event is a one off "single day" event or if it runs weekly or monthly | 8. Select the day that the event takes place. | 9. Once you have returned to the front end of the jukebox your event will display in the "what's On guide" and a full screen advert will automatically be displayed for the next 14 forthcoming events in the guide.



MANAGERS PHOTOS - SCATTER APP

1. Unlock the USB port on the left hand side of the VenueHub and Insert the memory stick containing your .jpg images into the USB slot. Press the correct button to tell the VenueHub where your images are. | 2. The VenueHub will upload your images. | 3. Select the images you wish to use. You can press the images individually or "select all" to use all the images. | 4. The scatter application will show your images as a full screen advert. | 5. When viewing the scatter application the user can drag images and enlarge them by clicking on the image. clicking again or off the image will reduce the image back to thumbnail polaroid size.

QUIZES, BINGO AND SCATTERED PHOTOS! YOU'LL BE AMAZED AT WHAT YOUR JUKEBOX CAN ACTUALLY DO!

Your VenueHub jukebox is an amazing piece of technology. Not only does the VenueHub have fantastic music capabilities, it can also provide your venue with simple tools and applications designed to help either advertise and promote events in your venue or create an excuse for an event itself such as a pub quiz or bingo night. These applications are built right into the VenueHub's system, all you have to do is set them free and start watching them work for you.

Whats On Events Guide

This feature enables a calendar of upcoming events to be inputted and displayed on the jukebox touch screen where it's always handy for customers to check what's coming up in the venue. Pre-programmable for years in advance, the 'What's On Guide' can automatically display regular on screen advertisements to promote any site events due to occur. This gives customers a single point for information about the activities in your venue, ensuring they always know what's on and when!

Sporting Events Guide

Pre-loaded with team logo's for every major UK and international football, Cricket and rugby team the Sports Event Advert facility, allows you to create quick on screen adverts featuring the teams logo's to promote the game coverage at your venue. The game will also be added automatically to the What's On Guide

Bingo

You can now play Bingo on any location without the need for a license as long as the stake and aggregate prize does not exceed £2000.00 in any rolling 7 day period. Bingo is a great way of attracting customers to the venue on quiet nights, featuring attractive on screen graphics and automated audio calls. The Auto Play facility makes it extremely simple to operate and regular on screen instructions ensure the winners keep coming!

Pub Quiz

The VenueHub's pub quiz takes the hassle out of staging professional, fun pub quizzes in your venue. Take control of the quiz and read out questions and answers from the screen or let the jukebox do all the work by selecting and playing the professionally recorded quiz questions automatically. Music questions even include audio clues in the form of music samples to help your valued customers!

Managers Photos (Scatter App)

A quick way to show a number of photos in a simple and interesting way. Load the photos onto a memory stick or CD and use the Managers Photos application to load them into the VenueHub. The images will display as the advert/application appears, as if to have been scattered as printed polaroids onto the VenueHub screen. Users can move these around, enlarge them and browse at will. Great for events and party nights where photos can be moved from digital camera to be displayed in your venue in a matter of minutes!

SETTING UP A NEW SPORTING EVENT



1. Press **New Sporting Advert** (by pressing **Edit Sporting Advert** you are able to edit existing adverts) | 2. If the game is an international game press **International**. This will enable international teams to be selected in the next stage of the process. | 3. Enter a date for the match | 4/5. Select the teams by following the instructions on screen. | 6. Enter a title and a message by pressing **Type Title** and **Type Message** and typing in your message using the onscreen keyboard. | 7. Enter the details of when your advert should start and finish (i.e the day after the game) and when the adverts should be shown. | 8. Similarly enter which days your advert should be shown. | 9. Your advert will now be shown as a mini advert on the main jukebox screen and also as an event in the "What's On Guide".